

MK12A(1 passages Pneumatic Rotary Union)

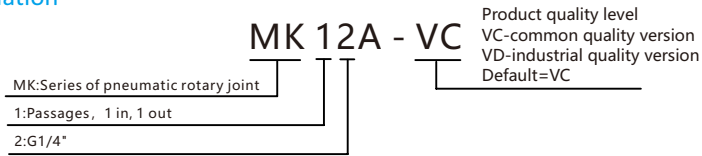

Mk12a series single channel rotary joint, interface size G1 / 4 ", compact structure, light weight, corrosion resistance, stainless steel shaft and aluminum shell All MK series models are equipped with male thread shaft and female thread shell as standard for easy installation.

Part# Explanation



MK12A Dimensions

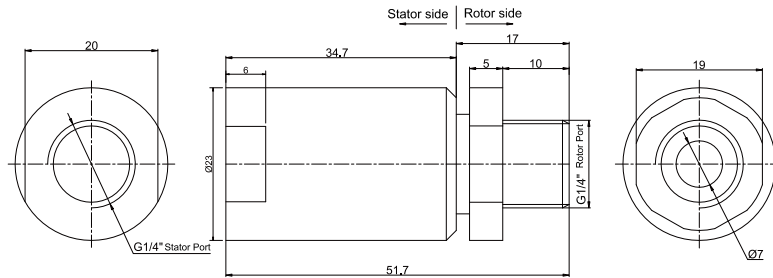

Part List

| Mk 12A Series Parts# List | | | |
|---------------------------|------------|-----------|---------------|
| Part# | Passages | Port Size | Pressure |
| MK12A | 1 in 1 out | G1/4" | 80KPa, Vacuum |

Specification

| Mechanical Data | | Rotary Joint Data | |
|----------------------|--|-------------------|--|
| Parameter | Value | Parameter | Value |
| Working life | Please see the product quality level table | Passage | 1 Passage |
| Rated Rotating Speed | Please see the product quality level table | Max Pressure | Vacuum-80KPa |
| Working Temperature | -30°C~80°C | Dielectric medium | Air, Vacuum |
| Operating Humidity | 0~85% RH | Torque | Related to the connection size, please see the product selection table |
| Sealing Element | Please see the product quality level table | | |
| Housing Material | Aluminum alloy / steel | | |
| Protection Grade | IP51 | | |

Product Quality Level Table

| Products Level Code | Max Rotating Speed | Working Life | Sealing Element |
|---------------------|--------------------|-----------------|--------------------------------|
| VC | 100RPM | 6 Million Revs | Seals of domestic famous brand |
| VD | 300RPM | 20 Million Revs | Imported Sealing elemen |

Options for custom slip ring

Note: Below special demands can be customized. According, the delivery date will be extended 3 to 15 days; also the cost will be increased 30% to 50%. Most of our basic parts are standard and modular, which can save the cost and lead time.