

MSP112 Separated Slip Rings

12 rings*2A

MSP112 separated slip ring is a type of minitype slip rings. It adopts a separated rotor and contact brushes combination, supporting 12 wires for signal or 2A. The exiting wires in stator and rotor are correspondingly six colored wires, it can simplify the electrical connection. The 90-degree angle V-groove design has the characteristics of smooth rotation, low torque and low electrical noise, which can exceed ordinary slip ring products.

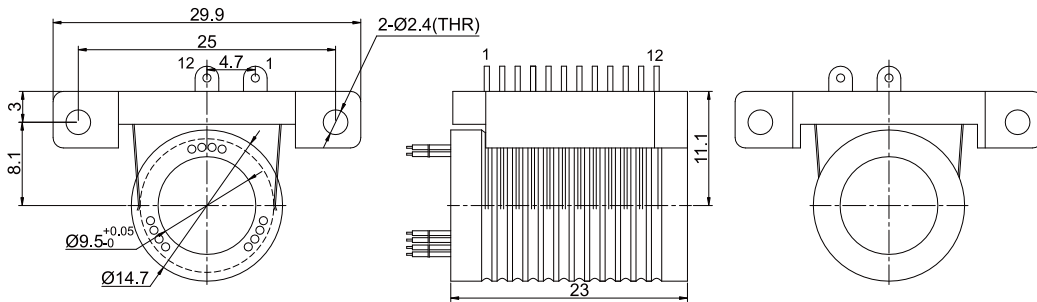

MSP1129 is the highest-end version of MSP112, which is used for military, aerospace, etc., differences as below

| Parts# | Max working speed | Working life | Torque | Electrical noise①@10Rpm |
|---------|-------------------|--------------|-----------|-------------------------|
| MSP112 | 250RPM | 20 million | 0.02 N•m | 10mΩ |
| MSP1129 | 1000RPM | 100 million | 0.005 N•m | 4mΩ |

Part# Explanation

| MSP112 Part# Explanation | | |
|--------------------------|--------------|------------------|
| Parts# | Signal or 2A | Products Level |
| MSP112 | 12 | Common quality |
| MSP1129 | 12 | High-end quality |

Note: N channels 2A rings parallel can be used as 1 channel N*2A current. For example: 2 rings 2A parallel could be used as 1 wires 4A

Specifications

| Electrical Data | | | Mechanical Data | |
|-----------------------|-----------------------------|----------------|---------------------|------------|
| Parameter | Value | | Parameter | Value |
| | Power | Signal | Working Temperature | -30°C~80°C |
| Rated Voltage | 0~240VAC/VD | 0~240VAC/VDC | Operating Humidity | 0~85% RH |
| Insulation Resistance | ≥1000MΩ/500VDC | ≥1000MΩ/500VDC | Contact Material | Gold-Gold |
| Lead Wires | AWG26#Teflon | AWG26#Teflon | Torque | IP40 |
| Lead Length | Standard 300mm (adjustable) | | | |
| Dielectric Strength | 500VAC@50Hz, 60s | | | |
| Electrical Noise | <0.01Ω | | | |

Lead Wires Color Code

| Ring | 1 | 2 | 3 | 4 | 5 | 6 | 7 | 8 | 9 | 10 | 11 | 12 |
|------|----|----|----|----|----|----|-----------|----|----|----|----|----|
| Code | BK | BN | RD | OG | YL | GN | DARK BLUE | PL | GY | ET | PK | BU |

Note: 6 wires for 1 group color, from 7-12, repeat the same color as 1...6, indicated with number code pipe.