

KCH Series Rotary Joints

Applicable medium	Temperature	Max pressure	Max Rotary Speed
Water	120°C	1.1Mpa	100RPM



Product Features

- ▲ Balanced sealing structure, long life cycle;
- ▲ Maintenance-free design, no lubricating oil required;
- ▲ Silicon carbide sealing ring structure, can adapt to harsh environment;
- ▲ Corrosion-resistant materials, can be used in water environment for a long time;
- ▲ Special structure for continuous casting machine cooling roll, heat radiation resistant.

Single Channel

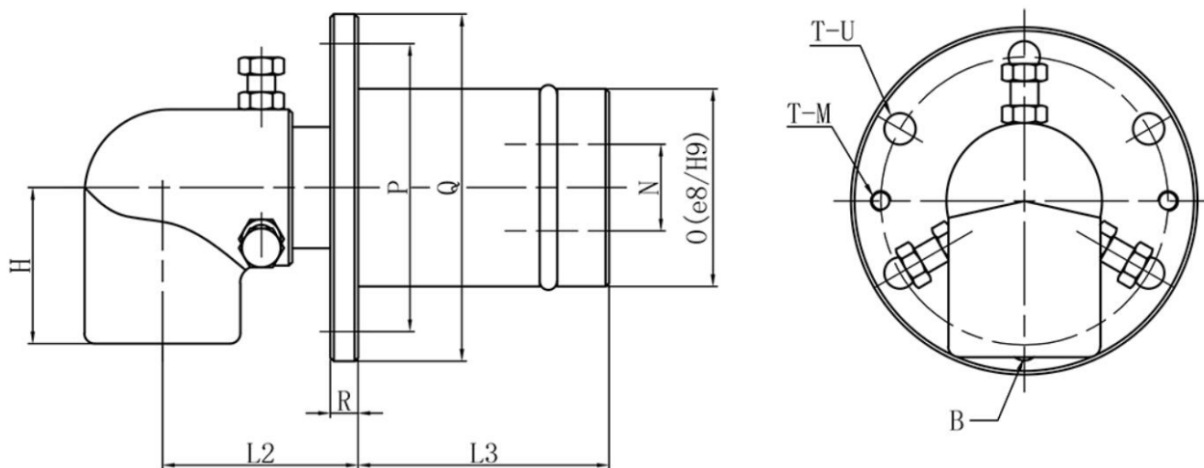

Model	B	H	N	O	P	Q	R	L2	L3	T-U	T-M
KCHM020F	3/4"	45	Φ20	Φ46	Φ72	Φ90	6.5	48.5	58.5	6-Φ7	2-M6
KCHM025F	1"	50	Φ25	Φ59	Φ83	Φ108	10	61.5	70	6-Φ7	2-M6
KCHM040F	1-1/2"	50	Φ38	Φ71	Φ98	Φ125	10	70	70	6-Φ7	2-M6

Two-Channel

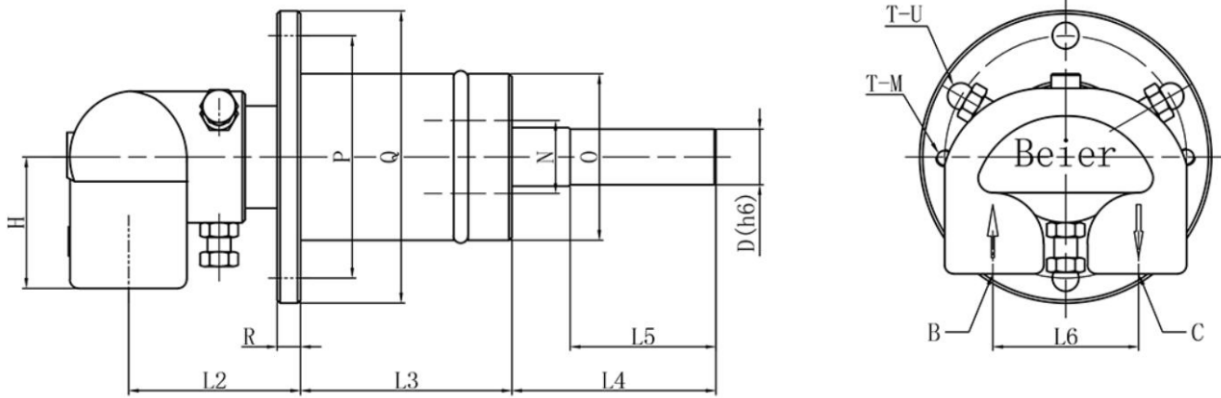

Two-Channel Model Selection table

Model	B	C	D	H	N	O	P	Q	R	L2	L3	L4	L5	L6	T-U	T-M
KCHM020F	1/2"	1/2"	13	41	Φ20	Φ46	Φ72	Φ90	6.5	48.5	58.5	31.5	30	50	6-Φ7	2-M6
KCHM025F	3/4"	3/4"	19	41	Φ25	Φ59	Φ83	Φ108	10	59	71.5	45	30	50	6-Φ7	2-M6
KCHM040F	1"	1"	29	43	Φ38	Φ71	Φ98	Φ125	10	74	73.5	60	30	64	6-Φ7	2-M6