

MSP112 Separated slip ring

12 rings*2A

MSP106 split slip ring is a kind of miniature slip ring, the use of separate rotor and contact brush combination, support 12 letters no. / 2A, stator and rotor lines corresponding to the use of 3-color color wire, so that the circuit connection is simplified. Conductive ring with 90 degree angle Vslot design, with smooth rotation, low torque and low electrical noise characteristics, which performance beyond the ordinary slip ring products.

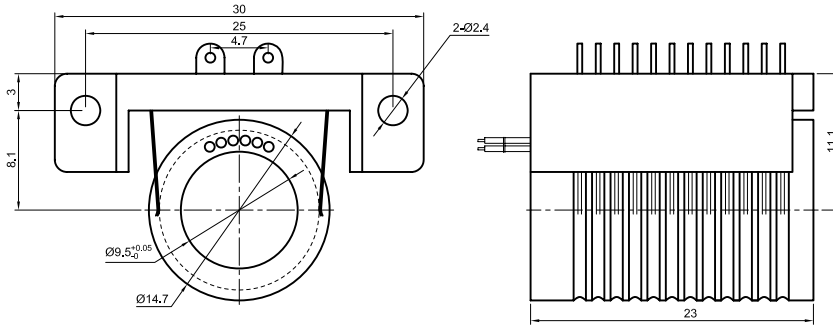

MSP1129 is MSP112 high-end version, which used for military, aerospace, etc., differences as below:

Parts#	Max working speed	Working life	Torque	Electrical noise①@10Rpm
MSP112	250RPM	20 million	0.02 N•m	10mΩ
MSP1129	1000RPM	100 million	0.005 N•m	4mΩ

Part# Explanation

MSP112 Part# Explanation		
Part#	Signal or 2A	Products Level
MSP112	12	Common quality
MSP1129	12	High-end quality

Specifications

Electrical data			Mechanical data	
Parameter	Value		Parameter	Value
	Power	Signal		
Rated Voltage	0~240VAC/VDC	0~240VAC/VDC	Working temperature	-30°C~80°C
Insulation Resistance	≥1000MΩ/500VDC	≥1000MΩ/500VDC	Operating Humidity	0~85% RH
Lead Wires	AWG26#eflon	AWG26#eflon	Contact Material	Gold-Gold
Lead Length	Standard 300mm (Can be extend)		Torque	IP41
Dielectric Strength	500VAC@50Hz , 60s			
Electrical Noise	<0.01Ω			

Lead Wires Color Code

Ring	1	2	3	4	5	6	7	8	9	10	11	12
Color	BLK	RED	YEL	GRN	BLU	WHT	BLK	RED	YEL	GRN	BLU	WHT

(6 wires for 1 group colors, from 7-12, repeat the same color as 1...6, indicated with number code pipe)