

K380 Series Rotary Joints

thoroughfare	Applicable medium	Max pressure	Max pressure	Temperature
B1 channel	Hydraulic oil	70bar	5bar/5000rpm 70bar/10rpm	90°C
B2 channel	Coolant	40bar	5000rpm	
	Capable of dry conversion	/		



Product Features

- ▲ Multi channel mechanical seal structure, suitable for high-speed rotating compressed air equipment;
- ▲ Two imported ball bearings support and rotate smoothly;
- ▲ Multi spring design structure provides stable spring force for the sealing surface;
- ▲ Balanced mechanical sealing design, reducing the impact of pressure changes and loads on the sealing surface, and extending the service life;
- ▲ The shell is equipped with observation holes to observe leakage and friction.

Dimension

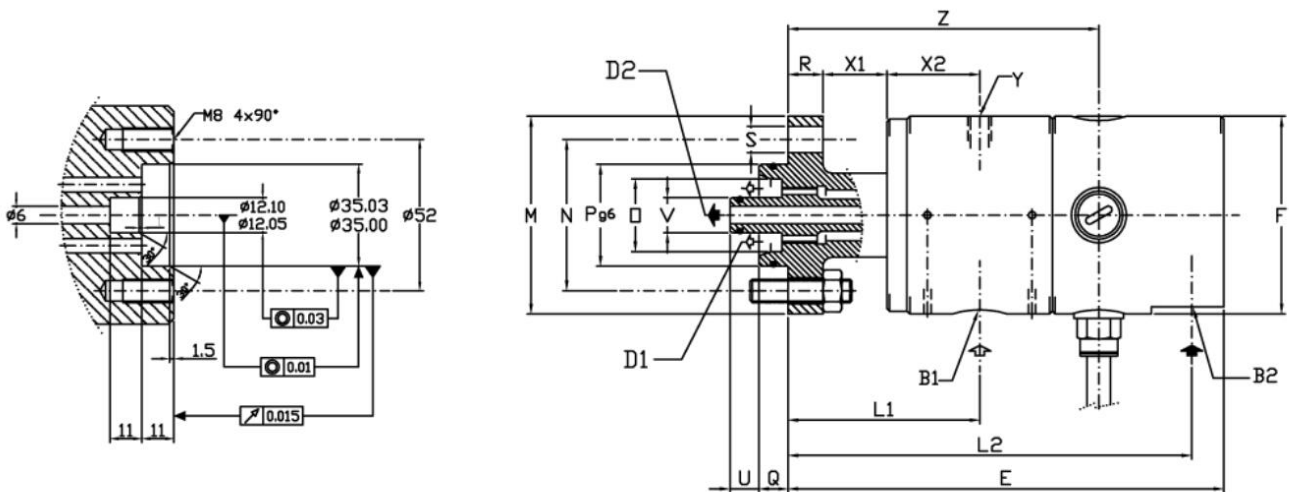

Dual channel using two different fluids

Model	B1-B2	D1	D2	E	φF	L1	L2	φM	φN	φO	φPg6	Q	R	φS	U	φV	X1	X2	Y	Z	Kg
K380-105-06F	G1/4"	40mm2	φ6 28mm2	150	68	66	139	68	52	25	35	10	12	94x90°	10	12	22	32	M8	107	1.5