

MWG100U-UG387-95GHz

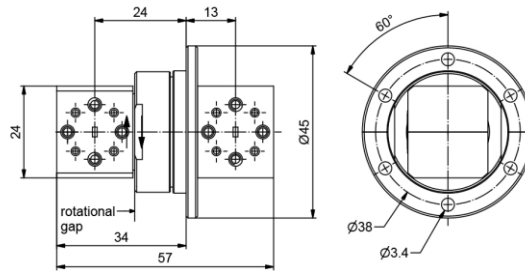

Rf channel characteristics

Interface , per M3922 / 67-010	UG-387 / U-mod
Style / interface in-line	U
Frequency range	93.0 - 95.0 GHz
Peak power , max	250 W
Average power . max	10 W
VSWR . max	1.5
VSWR WOW . max	0.2
Insertion loss . max	1.2dB
Insertion loss WOW . max	0.2dB

Conditions : Operating altitude if not pressurized , max 3000 m ; Load VSWR , max 2.0

General mechanical data

Rotating speed . max	300 rpm
Life . min	20 x 10 ⁶ revolutions
Starting torque , max	0.2 Nm@room temperature
orque during rotation , max	0.2 Nm@room temperature
Case material	copper alloy
Case surface finish	gold plated
Weight , approx	0.25 kg

General environmental conditions Operation

Ambient temperature range	-40°C+70°C
Relative humidity , max	95%
IP protection level	IP40